

1 Connect to a Computer

Quick Installation Guide

Wireless USB Adapter

Option 1: Directly

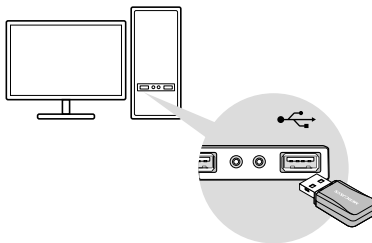

Option 2: Via the USB Extension Cable
(If provided)

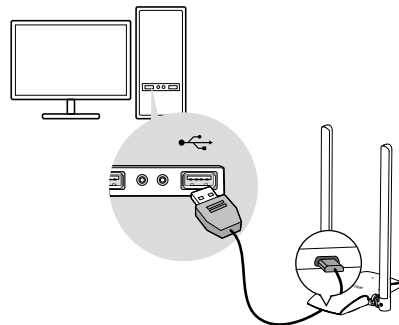

2 Install Driver

Follow **Method 1** if Driver CD is contained in your product package. If not, please try **Method 2**.

- **Method 1: via Driver CD**

- a. Insert the CD and run the setup program manually.

Note:

If there is no available CD drive on your computer, You can also download the latest driver at www.mercusys.com/support.

- b. Follow the pop-up instructions to complete the installation.

- **Method 2: via Internal Driver Installation**

- a. Go to **My Computer** or **This PC**.
- b. Find out **Mercusys** disk then run the **SetupInstall.exe** to start driver installation.

Note:

If you cannot find the **Mercusys** disk, download the driver at www.mercusys.com/support.

- c. Follow the instructions to complete the installation.

3 Join a Wireless Network

- a. Click the network icon () on the taskbar.
- b. Select your Wi-Fi network, click **Connect** and enter the password when prompted.



Troubleshooting

If you have problems during the installation, please refer to the following online FAQs.

T1. Check if the driver is successfully installed:

<https://www.mercusys.com/faq-262>

T2. How to Manually Install / Update Adapters on Windows 7: <https://www.mercusys.com/faq-263>

T3. How to Manually Install / Update Adapters on Windows 8: <https://www.mercusys.com/faq-261>

T4. How to Manually Install / Update Adapters on Windows 10: <https://www.mercusys.com/faq-265>

Support

For technical support, the user guide and more information, please visit <https://www.mercusys.com/support>.

- Do not attempt to disassemble, repair, or modify the device.
- Do not use the device where wireless devices are not allowed.
- Keep the device away from water, fire, humidity or hot environments.
- This product can be powered only by power supplies that comply with Power Source Class 2(PS2) or Limited Power Source(LPS) of IEC 62368-1.

Mercusys hereby declares that the device is in compliance with the essential requirements and other relevant provisions of the Radio Equipment Regulations 2017. The original UK declaration of conformity may be found at <https://www.mercusys.com/support/ukca/>

Mercusys hereby declares that the device is in compliance with the essential requirements and other relevant provisions of directives 2014/53/EU, 2011/65/EU and (EU) 2015/863. The original EU declaration of conformity may be found at <https://www.mercusys.com/en/ce>

