

Quick Installation Guide

4G LTE Outdoor Router

Setup with videos

Scan the QR code, or visit <https://www.mercusys.com/support/4g-wi-fi-routers/> and search for the setup video of your model.

For technical support, replacement services, user guides, and other information, please visit <https://www.mercusys.com/support/>

Images may differ from your actual product.

©2025 MERCUSYS 7100000055 REV1.0.0

In the Box

Outdoor Router

Mounting Bracket

Antenna x2

Self-tapping Screw x2

Wall Anchor x2

Mounting Strap x2

Power Adapter

Ethernet Cable

Installation Guide

Passive PoE Injector

1. Select Your Power Source

The outdoor router can be powered by a power adapter, a passive PoE injector, a PSE device (such as a PoE switch) which complies with Power Source Class 2 (PS2) or Limited Power Source (LPS) of IEC 62368-1.

Option 1: Via Passive PoE Injector

1. Connect the outdoor router to a Power over Ethernet (PoE) injector as illustrated below:

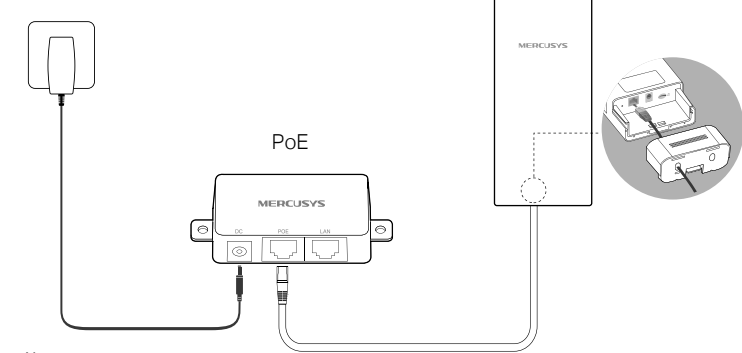

Notes:

1. The passive PoE injector supports a cable length up to 30 meters, but the value may vary due to the environment.
2. Ensure the Ethernet cable is connected to the POE port.

2. Find a suitable location to place the PoE injector or mount it on the wall as described below:

Place the PoE injector on the wall and mark the two mounting holes. Then drill into the holes, tap two wall anchors into the holes, and install two screws to secure the injector*.

*The wall anchors and screws are not included in the package.

Note: To ensure the passive PoE injector is attached most securely, it is recommended to install the injector with the Ethernet port facing upward.

Option 2: Via PoE Switch

Connect an Ethernet cable from the PoE switch to the Ethernet port.

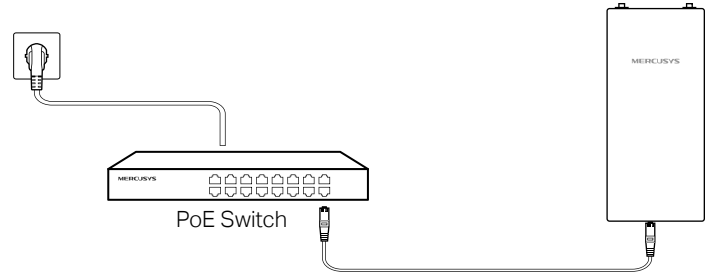

Option 3: Via Power Adapter

Plug one end of the included power adapter into the power port of the outdoor router and the other end to a standard electrical wall outlet. The product can only be powered via the normal building installation wiring.

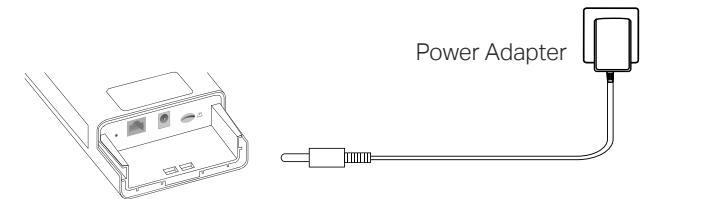

WARNING: Risk of Electric Shock.

For the US: Install the power cord plug only to indoor socket-outlets or to a covered Class A GFCI receptacle that has an enclosure that is weatherproof with the attachment plug cap inserted or removed.

For other regions: Install the power cord plug only to indoor socket-outlets or to outdoor socket-outlets with an enclosure which can be waterproof with the attachment plug cap inserted or removed.

2. Waterproof Your Router

1. Gently lift the tab on the waterproof cover and pull it outward to detach the waterproof cover.

2. With the gold contacts facing down, insert the nano SIM card into the slot until you hear a click.

3. Connect an Ethernet cable and/or a power adapter according to your network needs.

- **PoE-powered:** Ethernet cable only
- **DC-powered:** Wireless: Power adapter only
Wired: Ethernet cable + Power adapter

4. Reinstall the waterproof cover, leading the cable(s) through the slot(s) of the waterproof rubber.

3. Mount Your Router

Before You Start

Check the following LEDs' status. If the Internet LED is on, your outdoor router is connected to the internet successfully.

Power On Internet On Wi-Fi On

Note: If the Network LED does not turn on, please refer to FAQ-Q2 in this guide.

For better Internet connectivity, make sure 2 or 3 LEDs of the Signal LED are lit. Otherwise, try relocating the router to a spot where stronger mobile network signal can be received.

STEP 1 Connect the Antennas

Connect the antennas to the router. For optimal performance, adjust the direction of the antennas. It is recommended to keep the antennas vertical.

STEP 2 Mount the Router

The outdoor router can be mounted on a pole, wall or window. Choose a method that best suits you.

The outdoor router can only be used in upright direction as shown.

Option One: Pole Mounting

1. Lead the end of the pole mounting strap through the back of the router.

2. Position the router and wrap the pole mounting strap around the pole. Feed the end through the screw-block and tighten the strap until the router is secure.

Option Two: Wall Mounting

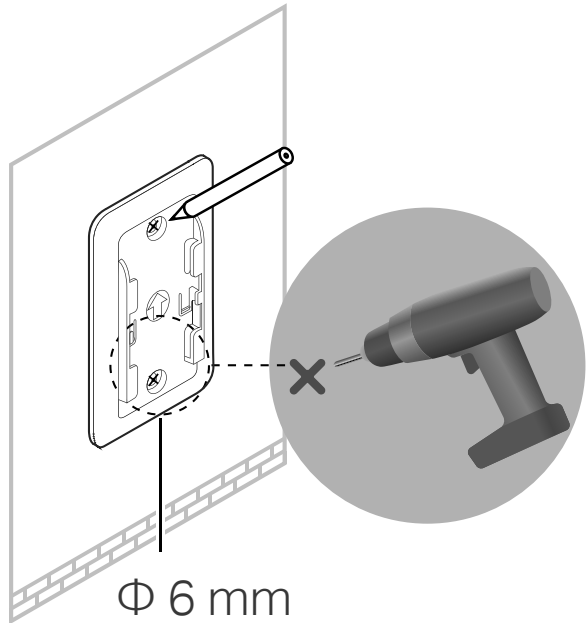

1. Choose a suitable location on the wall and mark the two drilling holes.
2. Drill two 6 mm diameter holes at the marked positions.

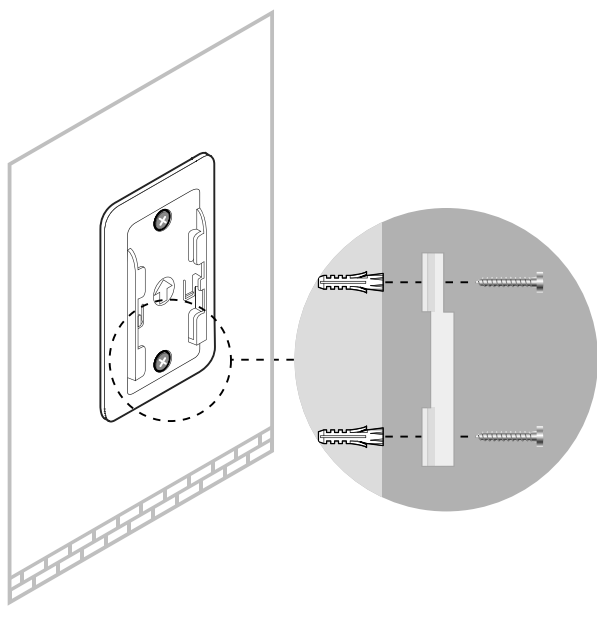

3. Tap the two wall anchors into the holes. Align the bracket with the wall anchors and install the two self-tapping screws to secure the bracket. Ensure the mounting bracket is not installed in the wrong direction.

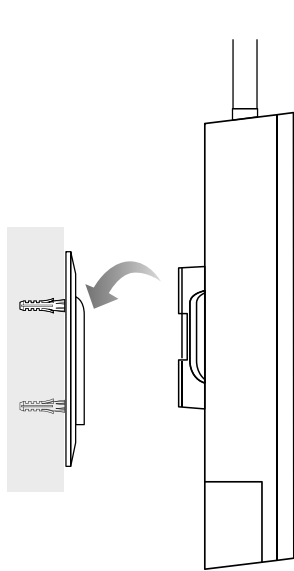

4. Hook the router onto the bracket and slide it downwards until it locks into place.

Option Three: Window Mounting

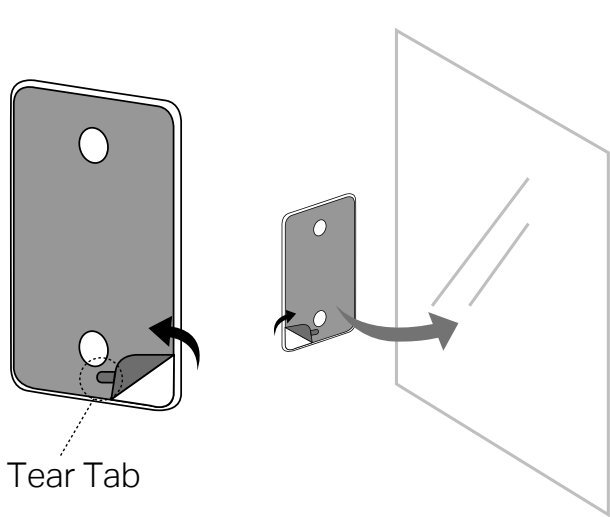

1. Tear off the release paper of double-sided adhesive tape and stick the bracket on the window. Apply slight pressure to ensure stronger bond.

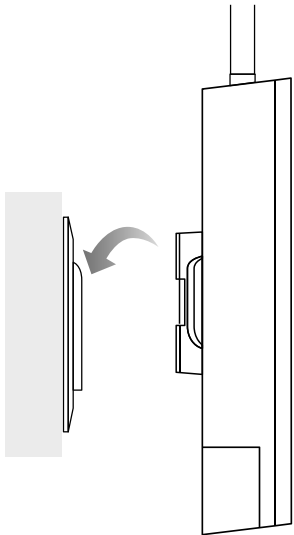

2. Hook the router onto the bracket and slide it downwards until it locks into place.

Notice

- Avoid air bubbles by applying enough pressure for at least 10 seconds.
- It is recommended that mounting on a window not be done on a wet or rainy day.
- Ensure that the selected window is clean, smooth and dry (a surface without ice, dust, oil or separating agents is recommended).
- Ideal tape application is accomplished when temperature is 21°C -38°C (70°F-100°F) and the bond is allowed to dwell 72 hours. Initial tape application to surfaces at temperatures below 10°C (50°F) is not recommended.

4. Set Up Your Router

Method ONE: Via MERCUSYS App

1. Download the MERCUSYS app via the app store or scan the QR code.



2. Open the app and log in with your MERCUSYS ID. If you don't have an account, create one first.

3. Tap LET'S BEGIN and select your device model. Follow the step-by-step instructions to complete the setup and connect to the internet.

😊 Enjoy the internet!

Method TWO: Via a Web Browser

1. Make sure your computer is connected to the router (wired or wireless). The default wireless network names (SSID) and password are printed on the label at the back of the router.

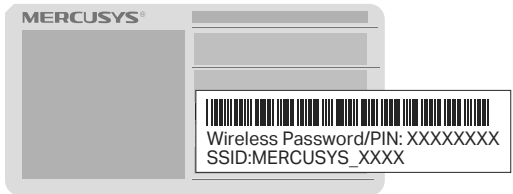

Note: Images may differ from actual products.

2. Launch a web browser and type in <http://mwlogin.net>. Create a password for future logins.

Note: If the login page does not appear, please refer to FAQ-Q1.

3. Follow the step-by-step instructions of the Quick Setup to complete the initial configuration.

😊 Enjoy the internet!

FAQ (Frequently Asked Questions)

Q1. What should I do if I cannot access the web management page?

- Reboot your router and try again.
- If the computer is set to a static IP address, change its settings to obtain an IP address automatically.
- Make sure <http://mwlogin.net> is correctly entered in the web browser.
- Use another web browser and try again.
- Disable and enable the active network adapter in use.

Q2. What should I do if I cannot access the internet?

- Verify that your SIM card is an LTE or WCDMA card.
- Verify that your SIM card is in your internet service provider's service area.
- Verify that your SIM card has sufficient credit.
- Log in to the router's web management page, and check the following:
 - 1) Go to **Advanced > Network > PIN Management** to verify if a PIN is required. If it is, enter the correct PIN provided by your ISP.
 - 2) Go to **Advanced > Network > Internet** to verify the parameters provided by your ISP are correctly entered. If they are incorrect, click **Create Profile** and enter the correct parameters, then select the new profile from the Profile Name list.
 - 3) Go to **Advanced > Network > Data Settings** to verify if the used data exceeds the allowance. If it does, click **Correct** and set the used data to 0 (zero), or disable **Data Limit**.
 - 4) Go to **Advanced > Network > Internet** to verify that Mobile Data is enabled. If it is not, enable it to access the internet.
 - 5) Confirm with your ISP if you are in a roaming service area. If you are, go to **Advanced > Network > Internet** to enable Data Roaming.

Q3. How do I restore the router to its factory default settings?

- With the router powered on, press and hold the **RESET** button on the side panel until the LED starts blinking, then release the button. Wait until the router reboots.
- Log in to the router's web management page, go to **Advanced > System Tools > Backup & Restore**, and click **Factory Restore**. Wait until the reset process is complete.

Q4. What should I do if I forget my wireless network password?

- The default wireless password is printed on the product label of the router.
- Connect a computer directly to the router via an Ethernet cable. Log in to the router's web management page and go to **Wireless** to retrieve or reset your wireless password.

Safety Information



- Keep the device away from fire or hot environments. DO NOT immerse in water or any other liquid.
- Do not attempt to disassemble, repair, or modify the device. If you need service, please contact us.
- Do not use the device where wireless devices are not allowed.
- Do not use damaged charger or USB cable to charge the device.
- Do not use any other chargers than those recommended.
- Adapter should be used indoors where the ambient temperature is lower than or equal to 40°C.
- Adapter shall be installed near the equipment and shall be easily accessible.
- The outdoor router can be used either indoors or outdoors.
- Before mounting your router outdoors, waterproof it to ensure device safety and performance.
- The waterproof cover must be secured before use!
- The product can only be installed by instructed person or skilled person!
- The plug on the power adapter is used as the disconnect device; the socket-outlet shall be easily accessible.
- Use only power supplies which are provided by manufacturer and in the original packing of this product. If you have any questions, please don't hesitate to contact us.
- Operating Temperature: -30°C to 60°C (-22°F to 140°F).

MERCUSYS hereby declares that the device is in compliance with the essential requirements and other relevant provisions of directives 2014/53/EU, 2009/125/EC, 2011/65/EU and (EU)2015/863. The original EU Declaration of Conformity may be found at <https://www.mercusys.com/en/ce>

MERCUSYS hereby declares that the device is in compliance with the essential requirements and other relevant provisions of the Radio Equipment Regulations 2017. The original UK Declaration of Conformity may be found at <https://www.mercusys.com/support/ukca/>

LED Indicator

LED	Status	Indication
Signal*	3 LEDs On 2 LEDs On 1 LED On All Off	The signal strength is above 75%. The signal strength is between 50% and 75%. The signal strength is below 50%. No mobile network signal.
LAN	On Off	The LAN port is connected. No LAN port is connected or LAN port is not connected properly.
Wi-Fi	On Off	Wi-Fi is enabled. Wi-Fi is disabled.
Internet	On Off	Internet service is available. Internet service is unavailable.
Power	On Flashing Off	The device is powered on and working normally. The device is initializing, RESET or upgrading. The device is powered off.

* More lit LEDs indicates better wireless signal strength.